

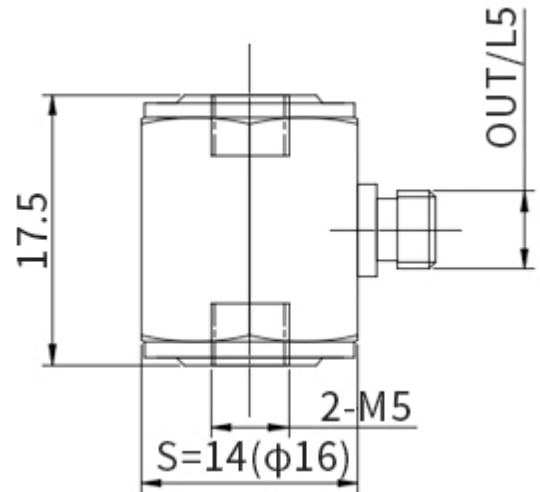

### Specifications:

Axial Sensitivity (20±5°C)	~ 3 pC/N
Tension and Compression Sensitivity Discordance	≤ 2%
Measurement Range	± 1 kN
Overload Capacity	120%
Non linearity	≤ 1% F.S.
Lag	≤ 1% F.S.
Non Repeatability	≤ 1% F.S.
Mounting Resonance Frequency	> 70 kHz
Operation Temp. Range	-54~+121 °C
Insulation Resistance	≥ 10 <sup>13</sup> Ω
Capacitance	~ 7 pF
Mounting Method	2-M5
Sensing Element	Quartz
Case Material	High-Strength Stainless Steel
Weight	~ 15 g
Output Type	L5 (side)
Grounding	Signal Ground Connected to Case
Low Noise Cable to BNC	Included
Calibration Certificate	Included



Schematic diagram

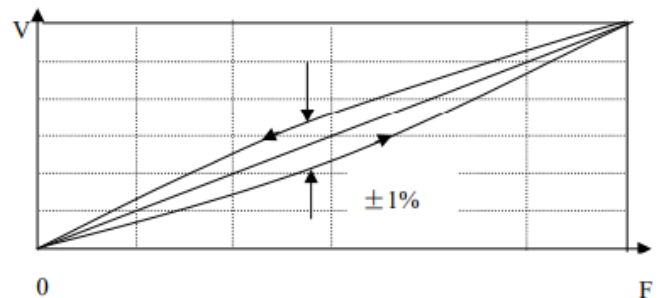

Typical static error curve (3 time average)